





Legend

-  Temporary diversion route - Service U1
-  Temporary diversion route - Service U2
-  Temporary diversion route - Service 20
-  Pedestrian Route

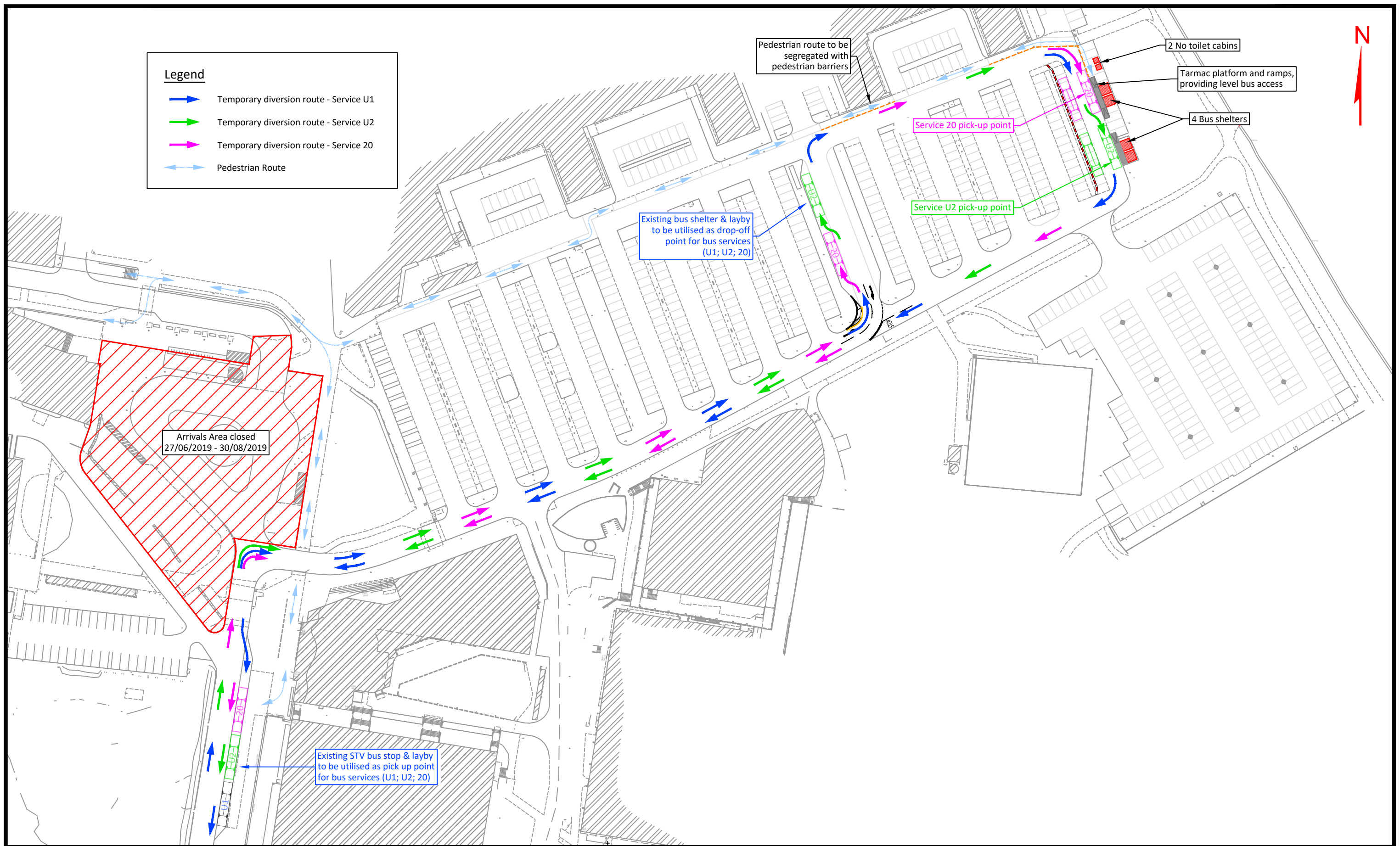

IMA TRANSPORT PLANNING
 11 KINGSMEAD SQUARE
 BATH BA1 2AB
 T: 01225 444 011
 www.ima-tp.com

CLIENT: **University of Bath**

PROJECT: **School of Management Arrivals Square Improvements**

TITLE: **Arrivals Square Closure Temporary Bus & Pedestrian Routes Firstbus Services U1, U2 and 20**

SCALE: (A3) 1:1000	CHECKED: SW	APPROVED: IMA
CAD FILE: IMA-17-123 D-013.dwg	DESIGN/DRAWN: OH	DATE: May 2019
PROJECT No: IMA-17-123	DRAWING No: D/013	REV: CO2