

# INTERNATIONAL EXCHANGE STUDENTS GUIDE 2024-25



UNIVERSITY OF  
**BATH**  
SCHOOL OF MANAGEMENT



**THINK  
AMBITIOUS.**



## DEAR EXCHANGE STUDENTS

Welcome to the School of Management at the University of Bath. We are incredibly lucky to be in a wonderful part of the world. Bath is a beautiful Georgian city, and we enjoy a fabulous hillside university campus with excellent facilities.

We bring the latest knowledge in business and management as well as depth of experience in business practice to our classrooms. Our academics combine their knowledge with an incredible ability to communicate lessons that are helpful to you. We have amazing students; they are from all over the world and bring a rich diversity to our classrooms. I invite you to take the opportunity to interact with them and take advantage of all we have to offer, including world-class faculty and facilities.

Professor Steve Brammer, Dean

## HIGHLY RANKED

We are one of the UK's leading business schools. We feature in the Financial Times' Top European Business Schools 2021 ranking and are in the top 20 most influential business 5 schools in the world for 'teaching power' in the Financial Times' Teaching Power Rankings 2021. This means we consistently deliver TOP outstanding teaching and learning for our students.

View our latest awards, accreditations and rankings on our website: [go.bath.ac.uk/rankings-and-accreditations](http://go.bath.ac.uk/rankings-and-accreditations)



**Ranked 1st in the UK for Marketing**  
*The Complete University Guide 2024.*  
*We've held this position since 2017.*



**Ranked 2nd in the UK for Accounting and Finance**  
*The Complete University Guide 2024*



**Ranked 3rd for Business and Management Studies**  
*The Complete University Guide 2024*



**Ranked top 5 for Business and Management Studies**  
*The Guardian University Guide 2024*

## THE SCHOOL OF MANAGEMENT'S NEW HOME

The School of Management has a new home. Opened in June 2022, it offers an airy, open layout which aims to foster collaboration and encourage students, academics and employers to work together.

Take a look at our [new building](#) on the University of Bath campus.



# 10 REASONS TO CHOOSE BATH



### Reputation and ranking

We are one of the UK's leading business schools, with a reputation for excellence in research and teaching. We are 1st in the UK for Marketing, 2nd in the UK for Accounting and Finance and 3rd for Business and Management Studies in The Complete University Guide 2024.



### A great sporting city

Bath Rugby Club is one of the oldest in the world. Everyone enjoys the excitement of a local game- grab some food, cheer on the players and immerse yourself in the fun atmosphere. Our state-of-the-art Sports Training Village on campus is open to all students.



### Backdrop for TV and film

Bath figures in many shows, including the recent smash-hit Netflix drama Bridgerton. It's not unusual to see camera crews busy filming around Bath. The city is also known for its connections to the famous British novelist, Jane Austen.



### Walk everywhere

The city is compact and easy to get around on foot. Living in Bath means you get all the convenience of living in a vibrant, historic city but with a friendly and safe community atmosphere.



### Open spaces

Bath has lots of parks and gardens to relax in or have a picnic, but if you're looking for something different, you can hire a rowing boat, paddleboard or canoe on the River Avon. The city is also surrounded by beautiful, green countryside- perfect for walking, running or cycling.



### UNESCO world heritage site

Bath is the only city in the UK to be a designated world heritage site in its entirety. There are loads of historic landmarks to visit around the city. This makes it the perfect setting for year-round events, including concerts, carnivals, and a variety of cultural exhibitions.



### Vibrant student atmosphere

Bath has a lively social scene, including a mix of clubs, cosy pubs, beautiful parks, and fascinating museums. There is something for everyone, any day of the week.



### Shop 'til you drop

Bath has a variety of shops, including high-street brands, artisan and vintage shops, and fashionable boutiques- all within easy walking distance. If you are here during Semester 1, check out the [Bath Christmas Market](#), which pops up in November through to December each year.



### Gateway to the UK and Europe

There are lots of ways to [travel to and from Bath](#) and you can easily explore the rest of the country and beyond by bus or train. You can be in London in an hour and a half and Bristol in 15 minutes. Bristol has an international airport which serves popular European destinations.



### Natural hot springs

The city gets its name from the famous Roman Baths, which are now a popular museum. Although you can't swim in them anymore, you can visit the nearby [Thermae Bath Spa](#) to have a modern-day relaxing experience. A highlight of the spa is its rooftop pool with views over the city.



## BEFORE YOU ARRIVE

### ADMISSIONS PROCEDURE

You will need to be nominated by your home institution. You will then be required to complete and return an [application form](#)

### HEALTH INSURANCE

We advise all students to obtain comprehensive medical insurance before they leave home.

✔ [Healthcare in the UK](#)

### VISAS

UK immigration and border legislation is subject to change so we advise students to check up-to-date guidance.

✔ [Home office immigration advice](#)

### WHAT CAN I STUDY?

✔ [Business, Management, Accountancy & Finance Courses](#)

✔ [English Language Courses](#)

✔ [British Culture & Literature courses](#)

✔ [Courses from other departments](#)



### ACCOMMODATION

We have a wide variety of on and off- campus accommodation. Frequent bus services link the campus, city and major student residential areas.

✔ [Pulteney Court](#)

✔ [Thornbank Gardens](#)

### COST OF LIVING

It is very important to begin your studies knowing that you have enough funding to support yourself. [Here](#) is a breakdown of average weekly living costs for Bath University students.

## ON ARRIVAL



### ORIENTATION

The University runs a full programme of orientation activities to help new students settle in quickly.

### BATH BUDDIES

The Bath Buddy programme aims to help new students establish a social network from day one. You will be introduced to your Buddy in the first teaching week of the semester. They will be able to give informal advice, help you find your way around campus and introduce you to living and studying in Bath.

### MEDICAL CENTRE

The University [Medical Centre](#) is situated on campus and offers a range of services.



### VIRTUAL CAMPUS TOUR

[Click here](#) to use our virtual tour to explore the campus and our accommodation.

*"Bath is a beautiful city. It is now my second home. The student atmosphere makes this city very happy and full of life. There are always things to do: walking around, having a picnic in front of the crescent, watching a rugby match... Bath has excellent transport connections, so it is easy to visit London for the weekend or travel around the UK or Europe during Easter Break. The months of exchange will fly by so fast; you will want to stay for longer."*

**BLANCA GASSET CORTEJARENA**  
ICADE Business School, Spain





# ARTS

The Edge is the hub of creative life on campus. Here you'll find opportunities to participate in visual arts, music and dance using top-class facilities.



# PRACTICALITIES

## LIFE ON CAMPUS

Our welcoming campus is safe and friendly, with first-class arts and sports facilities. It provides a real feeling of community for those living, working and studying here. It is one of the safest campus sites in the UK and we are the first university in the country to win a national police approved security award. The campus has excellent places to eat, drink and socialise. Facilities include food shops, post office, and a library open 24/7. The Students' Union forms an important part of the student experience. There are over 100 clubs and societies to get involved in and the union bar and nightclub arranges a variety of events.

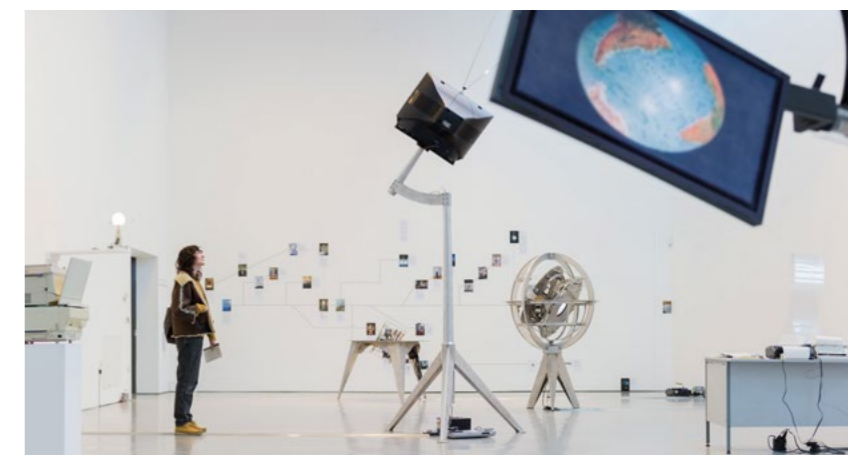

## STUDENT SUPPORT & RESOURCES

We offer a wide range of specialist student support services and resources on campus:

- ✔ [Student Services](#)
- ✔ [Wellbeing](#)
- ✔ [Health & Safety](#)
- ✔ [What's On](#)
- ✔ [Money Matters](#)
- ✔ [Virgil Building](#)

# SPORT

The University of Bath was named Sports University of the Year 2018. The Sports Training Village offers a fantastic range of sports, for the recreational and elite athlete alike. Our outstanding facilities and expertise are open to all.



## TRANSPORT

The University is located a mile from the city centre and frequent bus services link the campus, city and student residential areas:

- ✔ [Bus links to campus](#)
- ✔ [Cycling and Walking to campus](#)



# ACADEMIC LIFE



## ACADEMIC CALENDAR

Semester 1	
Start of orientation	23rd September 2024
Start of teaching	30th September 2024
End of teaching	13th December 2024
Exam period	6th January – 25th January 2025

Semester 2	
Start of orientation	30th January 2025
Start of teaching	3rd February 2025
End of teaching	17th April 2025
Exam period	6th May – 30th May 2025

## STUDENT RESOURCES

The following resources are an essential part of academic life:

- ✓ [Moodle](#)
- ✓ [SAMIS](#)
- ✓ [Library](#)
- ✓ [MyTimetable](#)
- ✓ [Academic Skills](#)

## COURSE LOAD

Exchange students should take a minimum of 4 units (24 ECTS credits) and can take up to 5 units (30 ECTS) per semester. Management Units may only be selected from Years 2 and 3 (units starting with MN2) and from Year 4 (MN3). Changes of units are only allowed until the end of the first week of the term. If you wish to make changes to the units you have chosen for the current semester you must complete a CC4 form. [School of Management Units for Exchange Students.](#)



## ASSESSMENT

Units are assessed by coursework and examinations. All exchange students are required to take all forms of assessment associated with each of their chosen units. We can only arrange alternative assessment in Semester 1, if our assessment period clashes with the start of the student's semester at home, and only at the request of the home institution.

## GRADING

The normal unit pass mark is 40%

Degree class	Bath mark %	USA grade
I (Excellent)	70 or over	A+
II.i (Very Good)	66 to 69	A
	64 to 65	A-
	60 to 63	A
II.ii (Good)	55 to 59	B
	50 to 54	B-
II (Satisfactory)	46 to 49	C+
	44 to 45	C
	40 to 43	C-
	38 to 39	D+
Borderline Fail	36 to 37	D
	35	D-
Fail	34 or under	F

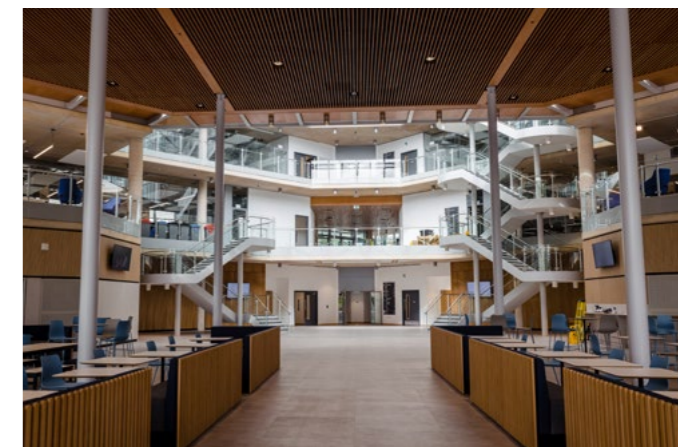

ECTS grade	% students achieving grade	Definition
A	70 or over	Excellent
B	66 to 69	Very good
C	64 to 65	Good
D	60 to 63	Satisfactory
E	55 to 59	Sufficient
FX	50 to 54	Fail
F	46 to 49	Fail

## RESULTS AND RETRIEVALS

Students can see their results on-line usually in March (S1) and July (S2). Official transcripts will be sent to the home institution in April (S1) and in August (S2). We do not set retrievals for exchange students but we can organise them by exception at the sending institution's specific request. This does not apply to final year units (MN3).

## MITIGATING CIRCUMSTANCES

If a student's performance is affected by medical or personal circumstances an [IMC](#) should be submitted.

## REFERENCING & PLAGIARISM

All students must be familiar with the University's guidelines on referencing and plagiarism. The University of Bath recommends students use the [Harvard System](#).

## THE ACADEMIC INTEGRITY TEST

This must be completed by all students and failure to do so may delay the release of your transcript.

Click here for more information on the [The Academic Integrity Test](#)

*"It was a magical experience to live daily life in such a beautiful city like Bath. From the first day I was here, I fell in love with the architecture, the river, the Royal Crescent and the parks. Also, I think this is the perfect city for young people because everything is within walking distance, there are a lot of pubs and discos, and a great part of the population is young."*

**FRANCISCO VALDÉS CRUZAT**  
Pontificia Universidad Católica de Chile, Chile



*"I love the study life balance at Bath. There are a variety of activities that the University offers. For example, the School of Management held orientation activities, a leavers' party, bus tour, and an afternoon tea meeting. The Student Union had a lot of study well events and student club activities. Those activities are excellent opportunities to meet different people and make friends. Also, the lectures and seminars I had were very interactive, and the duration of each session was just perfect."*

**SZE NGA KWAN**  
City University, Hong Kong



# OUT AND ABOUT



## LIFE IN BATH

The World Heritage City of Bath is one of the most interesting, elegant and vibrant cities in the UK. It is known for its many beautiful buildings and the natural hot springs which gave the city its name. Bath is home to excellent museums and galleries and hosts arts, music and food festivals throughout the year. There are numerous restaurants, cafés, pubs and nightlife, and a great range of shopping with high street stores, small specialist shops and markets. [Life in Bath](#)



Bath is the only UK city on UNESCO's World Heritage list



## LIFE IN THE UK

The UK is a diverse and multi-ethnic society, where students of all backgrounds are welcome and their involvement in local communities is valued.

### British life & culture

[Visit Britain](#) has all the information you need to plan your trips around the UK during your semester at Bath.

## CULTURE SHOCK

While you are living abroad, you may experience certain emotional reactions to your new environment. These feelings are completely normal and are commonly referred to as **"culture shock"**.

## CLIMATE

Bath has cool, wet winters and warm, wet summers. The weather conditions are also very changeable.

\*Climate period: 1991-2020.  
Source: [metoffice.gov.uk](#)

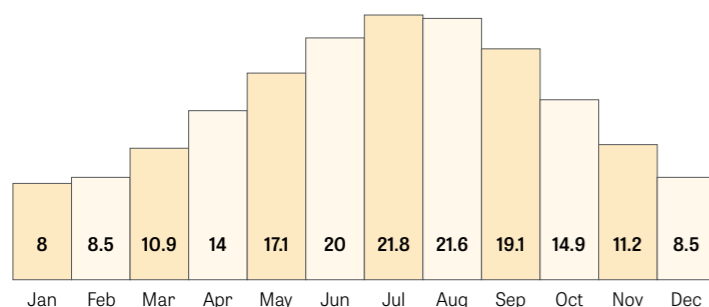

Average maximum temperature (°C)\*

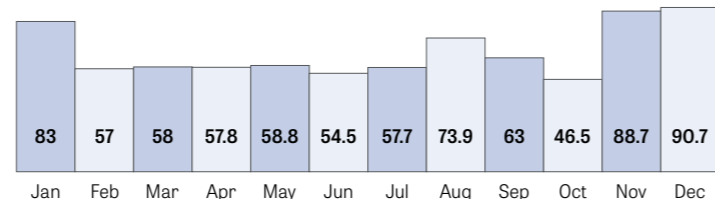

Average rainfall (Days of rainfall >= 1 mm)\*

## CONTACTS

The International Relations Team are here to help with any aspect of your time at Bath.

### Clare Woolfe

International Relations Manager  
Tel +44 1225 38 5182  
[caw56@bath.ac.uk](mailto:caw56@bath.ac.uk)

### Helen Friend

International Relations Officer  
Tel +44 1225 38 4588  
[international-relations.som@bath.ac.uk](mailto:international-relations.som@bath.ac.uk)



## WEBPAGES AND SOCIAL MEDIA

School of Management:  
[bath.ac.uk/schools/school-of-management](http://bath.ac.uk/schools/school-of-management)

Incoming students:  
[bath.ac.uk/management/international/exchange](http://bath.ac.uk/management/international/exchange)



University of Bath School of Management



@BathSofM  
#MySoMMSc



@BathSofM  
#MySoMMSc



University of Bath School of Management



"I enjoyed the whole exchange experience! Bath is such a beautiful city. It's the first time that I had lived in student accommodation, so I enjoyed the independence, but also felt that I could turn to the accommodations team or the international relations team if I needed something. I made loads of new friends who are from all over the world and had the chance to travel to places such as London, Oxford, Scotland, and Italy. There were also amazing events organised for us including an evening party at the Roman Baths and a Farewell Cream Tea event."

**RALPH ARO**  
HEC Montréal, Canada